

Length Unit: mm

d	L	Grip Range		Hole Size	dk	k	dm	p	Minimum Compressive	Minimum Shear Force
	±0.99	min	max	Φ		max	max	min	N	N
Φ3.0 +0.08 -0.15	6.0	1.0	3.5	3.1-3.2	5.4-6.3	1.3	2.1	27	2200	1800
	8.0	3.5	5.0							
	10.0	5.0	7.0							
	12.0	7.0	9.0							
	14.0	9.0	11.0							
	16.0	9.0	12.5							
	18.0	12.0	14.5							
20.0	13.0	16.5								
Φ3.2 +0.08 -0.15	6.0	1.0	3.5	3.3-3.4	5.8-6.7	1.3	2.1	27	2500	1900
	8.0	3.5	5.0							
	10.0	5.0	7.0							
	12.0	7.0	9.0							
	14.0	9.0	11.0							
	16.0	9.0	12.5							
	18.0	12.0	14.5							
20.0	13.0	16.5								
25.0	15.0	21.5								
Φ4.0 +0.08 -0.15	6.0	1.0	3.0	4.1-4.2	6.9-8.4	1.7	2.6	27	3500	2700
	8.0	3.0	5.0							
	10.0	4.0	6.5							
	12.0	6.0	8.5							
	14.0	7.0	10.5							
	16.0	8.0	12.5							
	18.0	10.0	14.5							
	20.0	12.0	16.0							
	25.0	16.0	21.0							
30.0	21.0	26.0								
35.0	26.0	30.5								
40.0	30.5	35.0								
Φ4.8 +0.08 -0.15	6.0	1.0	2.5	4.9-5.0	8.3-10.1	2.0	3.1	27	5000	4000
	8.0	2.5	4.0							
	10.0	4.0	6.0							
	12.0	6.0	8.0							
	14.0	8.0	10.0							
	16.0	8.0	12.0							
	18.0	10.0	14.0							
	20.0	12.0	16.0							
	25.0	16.0	21.0							
	30.0	21.0	25.0							
	35.0	25.0	30.0							
40.0	30.0	35.0								
45.0	35.0	40.0								
50.0	40.0	45.0								
Φ6.4 +0.08 -0.15	8.0	1.5	3.0	6.5-6.6	11.6-13.4	2.7	4.2	27	9300	7500
	10.0	2.0	4.0							
	12.0	3.0	6.0							
	14.0	6.0	8.0							
	16.0	6.0	10.0							
	18.0	8.0	12.0							
	20.0	10.0	14.0							
	25.0	14.0	18.0							
	30.0	18.0	23.0							
35.0	23.0	28.0								
40.0	28.0	33.0								

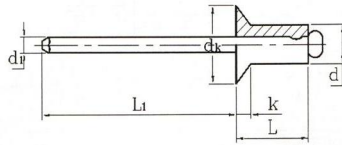

**Stainless Steel
/Stainless Steel
Blind Rivet
Countersunk Head**

Length Unit: mm

d	L	Grip Range		Hole Size Φ	dk	k max	d ₁ max	L ₁ min	Minimum Compressive N	Minimum Shear Force N
		min	max							
Φ3.0 +0.08 -0.15	6.0	1.0	3.5	3.1-3.2	5.4-6.3	1.3	2.1	27	2200	1800
	8.0	3.5	5.0							
	10.0	5.0	7.0							
	12.0	7.0	9.0							
	14.0	9.0	11.0							
	16.0	9.0	12.5							
	18.0	12.0	14.5							
20.0	13.0	16.5								
Φ3.2 +0.08 -0.15	6.0	1.0	3.5	3.3-3.4	5.8-6.3	1.3	2.1	27	2500	1900
	8.0	3.5	5.0							
	10.0	5.0	7.0							
	12.0	7.0	9.0							
	14.0	9.0	11.0							
	16.0	9.0	12.5							
	18.0	12.0	14.5							
20.0	13.0	16.5								
25.0	15.0	21.5								
Φ4.0 +0.08 -0.15	6.0	1.0	3.0	4.1-4.2	6.9-7.5	1.7	2.6	27	3500	2700
	8.0	3.0	5.0							
	10.0	4.0	6.5							
	12.0	6.0	8.5							
	14.0	7.0	10.5							
	16.0	8.0	12.5							
	18.0	10.0	14.5							
	20.0	12.0	16.0							
	25.0	16.0	21.0							
	30.0	21.0	26.0							
35.0	26.0	30.5								
40.0	30.5	35.0								
Φ4.8 +0.08 -0.15	6.0	1.0	2.5	4.9-5.0	8.3-9.5	2.0	3.1	27	5000	4000
	8.0	2.5	4.0							
	10.0	4.0	6.0							
	12.0	6.0	8.0							
	14.0	8.0	10.0							
	16.0	8.0	12.0							
	18.0	10.0	14.0							
	20.0	12.0	16.0							
	25.0	16.0	21.0							
	30.0	21.0	25.0							
	35.0	25.0	30.0							
40.0	30.0	35.0								
45.0	35.0	40.0								
50.0	40.0	45.0								

